

Refer to Part Sheet: SBBI-2-181

Customer Service  
1-800-445-3988

## Model M1-G HVLP Gravity Feed Spray Gun 901210 (6924-0000-0)

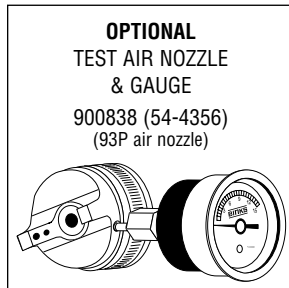
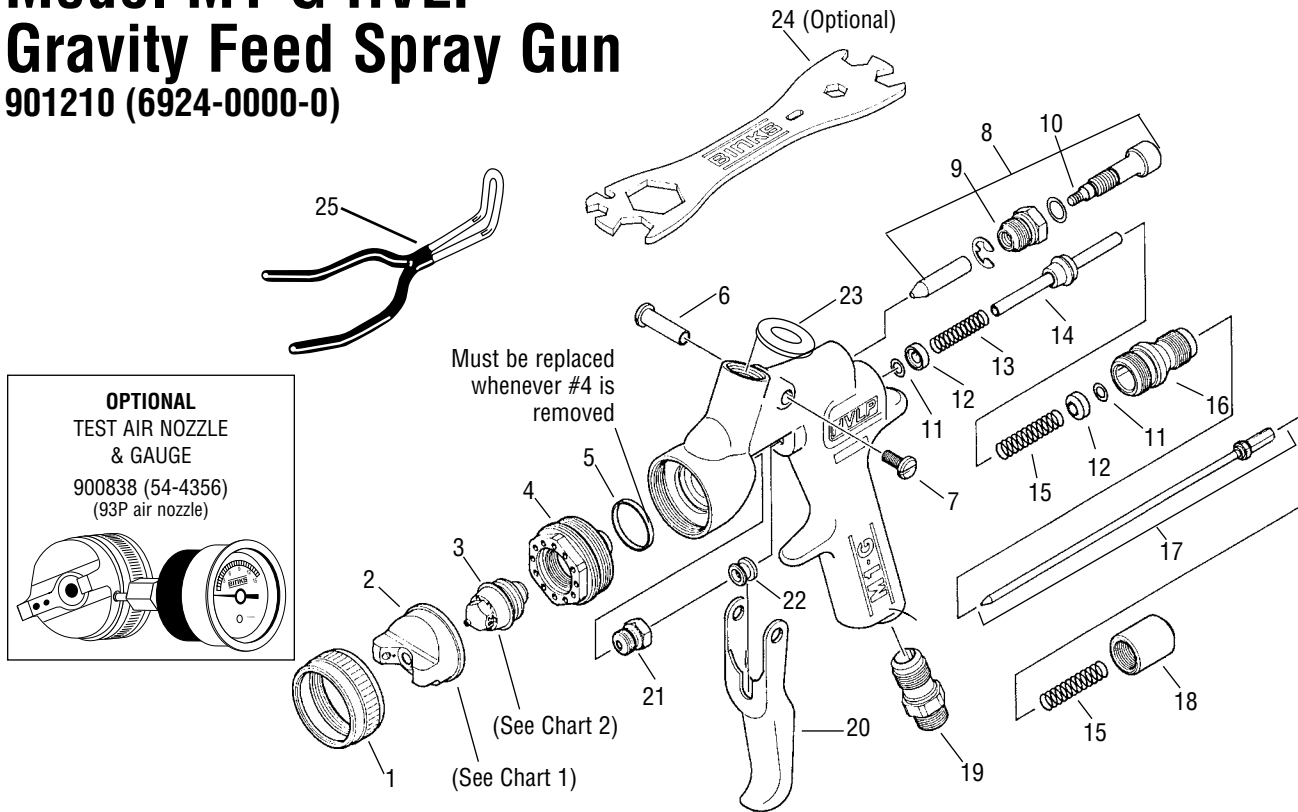

No.	Order No.	Model No.	Description	Parts Req'd
1	900636	54-3531	Retaining Ring	1
2	See Chart 1	See Chart 1	Air Nozzle	1
3	See Chart 2†	See Chart 2†	Fluid Nozzle	1
4	900848†	54-4368†	Head Insert	1
5	900850▲	54-4369-5▲	Head Insert Seal Ring (Kit of 5)	1
6	●	●	Trigger Stud	1
7	●	●	Trigger Screw	1
8	900843†	54-4364†	Side Port Control Assembly	1
9	▲	▲	Retaining Ring	1
10	▲	▲	O-Ring	1
11	▲★	▲★	O-Ring	2
12	★	★	Seal Retainer	2
13	▲*	▲*	Spring, Yellow	1
14	900623▲	54-3512▲	Spindle Assembly	1
15	▲*	▲*	Spring, Blue	2
16	900640†	54-3541†	Housing	1
17	900858	54-4382	ABSS Needle	1
18	900659	54-3606	Material Valve Control Knob	1
19	900990†	54-768†	Air Connection	1
20	900841	54-4360	Trigger	1
21	900851▲	54-4370▲	Seal Cartridge Assembly	1
22	●	●	Valve Spindle Cap	1
23	192151▲	KGP-13-K5▲	Cup Gasket (Kit of 5)	1
24	900712	54-3918	Wrench (Optional)	1
25	192219	192219	Gun Holder, Coated	1

▲NOTE: Gun Repair Kit 900847 (54-4367-1) Contains:

Ref. No.	Description	Qty.	Ref. No.	Description	Qty.
5	Seal	1	14	Spindle	1
9	Retaining Ring	1	15	Spring, Blue	2
10	O-Ring	1	21	Seal Cartridge	1
11	O-Ring	2	23	Cup Gasket	1
13	Spring, Yellow	1			

*Spring Kit 900927 (54-5225)		
No.	Description	Qty.
13	Spring, Yellow	1
15	Spring, Blue	2

★O-Ring & Retainer Kit 900926 (54-5224)		
No.	Description	Qty.
11	O-Ring	2
12	Seal Retainer	2

†Torquing Information		
No.	Description	Torque
3	Fluid Nozzle	10-12 Ft. Lb.
4	Head Insert	20-23 Ft. Lb.
8	Side Port	4-6 Ft. Lb.
16	Housing	15-17 Ft. Lb.
19	Air Connection	15-17 Ft. Lb.

●Screw, Stud & Cap Kit 900925 (54-5223)		
No.	Description	Qty.
6	Trigger Stud	1
7	Trigger Screw	1
22	Valve Spindle Cap	1

### Chart 1

Includes		
Air Nozzle	Ring	Order No.
92P	NO	900371 (46-9505)
93P	NO	900361 (46-9300)

### Chart 2

Fluid Nozzle	Order No.	I.D. Size In.	MM
92	900311 (45-9200)	.046	1.2
93	900313 (45-9300)	.052	1.3
94	900314 (45-9400)	.055	1.4
97	900321 (45-9700)	.070	1.8

**NOTE: See page 44 for GFC-502 Cup parts breakdown.**

